



## Technical Specifications

Accuracy:	< ±2% of FS range under constant conditions
Analysis:	0-100% oxygen
Application:	Verify O <sub>2</sub> content of scuba compressed air tanks
Calibration:	Certified dry 100% oxygen or air after 8 hrs of use
Compensation:	Temperature
Connections:	1x16 mm thread (see options below)
Controls:	Soft touch keypad for ON/OFF and Calibration
Dimensions:	2.72" x 4.1" x 1.35"; weight 7 oz. (196 grams)
Display:	3 digit LCD 1.1" x .625"; resolution 0.1% O <sub>2</sub>
Flow Sensitivity:	None between 0.2 to 10 liters per minute
Humidity:	Non-condensing 0-95% RH
Linearity:	± 1% under constant conditions
Pressure:	Inlet - ambient or regulated; vent - atmospheric
Power:	(2) 1.5V AA alkaline batteries; 13,000 hrs of use
Response Time:	90% of final FS reading in 10 seconds
Sensitivity:	< 0.5% of FS range
Sensor:	AII-11-75-PO2 D
Sensor Life:	32 months in air at 25°C and 1 atmosphere
Storage Temp.:	-20° to 60°C (-4°F to 140°F) on intermittent basis
Temp. Range:	5° to 45°C (41°F to 113°F)
Warm-up Time:	None
Warranty:	12 months analyzer; 12 months sensor

**NEW**



## ***Palm O<sub>2</sub> D Oxygen Analyzer***

## Options & Accessories

- AII-11-75-PO2R D Remote Oxygen Sensor Kit
- A-3388 Adapter, Dome to Sensor
- A-3609 Adapter, Dome to 1/8" Tube
- A-3671 Adapter, BC with Restrictor to Sensor
- A-3673 Adapter, BC with Restrictor to 1/8" Tube
- A-3676 Adapter, 1/8" Tube to Sensor
- A-3677 Adapter, DIN to 1/8" Tube
- A-3678 Adapter, A-Yoke to 1/8" Tube
- FITN-1009 Tee Adapter 15mm ID x 22mm ID x 22mm OD
- FITN-1112-1 Flow Diverter
- HRWR-1157 Screwdriver
- HRWR-1158 Lanyard
- TUBE-1018 Tubing, 1/8" x 3'
- A-3657-1 Dovetail Mounting Kit
- HRWR-1075 Dovetail Female Clamp Pole/Shelf

- Easy user interface ... one touch controls
- Simple to use ... accurate reliable results
- One touch calibration ... 100% O<sub>2</sub> or air
- Long battery life ... 13,000 hrs of use
- Advanced sensor technology
- State of the art electronics
- Certified ISO 9001:2008 QA System

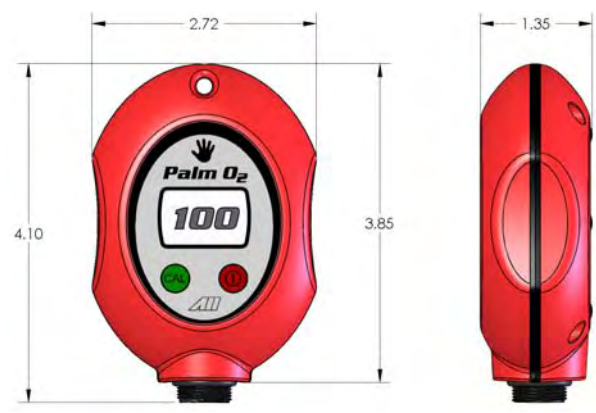



**NEW**

# Palm O<sub>2</sub> D Oxygen Analyzer

Simple to use ... accurate reliable results

One touch calibration ... 100% O<sub>2</sub> or air

Long battery life ... 13,000 hrs of use

Advanced sensor technology

Certified ISO 9001:2008 QA System



## Optional Accessories



A-3388 Adapter,  
Dome to Sensor



A-3676 Adapter,  
1/8" Tube to Sensor

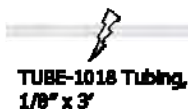

TUBE-1018 Tubing,  
1/8" x 3'



A-3609 Adapter,  
Dome to 1/8" Tube

A-3657-1 Dovetail Mounting Kit

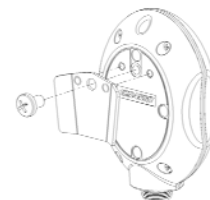

A-3657 Dovetail Bracket  
HRWR-1162 Screw 1/4-20 x 3/8"



A-3671 Adapter, BC with  
Restrictor to Sensor



A-3673 BC with  
Restrictor to 1/8" Tube



A-3678 Adapter,  
A-Yoke to 1/8" Tube

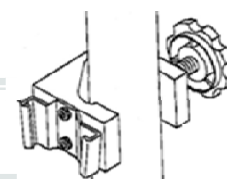

HRWR-1075 Dovetail  
Clamp Pole or Shelf

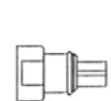

FITN-1112-1  
Flow Diverter



FITN-1009  
Tee Adapter

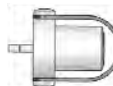

A-3677 Adapter, DIN  
to 1/8" Tube

## Palm O<sub>2</sub> R D Oxygen Analyzer, Remote Oxygen Sensor



Oxygen Analyzer with A-3654  
Remote Sensor Connector



CABL-1009 Cable 6 ft.  
Phone Plug with Lock Nut

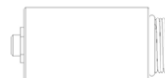

AII-11-75-PO2R  
Oxygen Sensor

HRWR-1157 Screwdriver

HRWR-1158 Lanyard